



PRESERVE AT SAN TAN - PAPAGO COLLECTION

Cordova Contemporary Farmhouse

HOME SITE 631 | 3922 W GARDEN GROVE DR | SAN TAN VALLEY, AZ 85142

Designer Appointed Features | EXTERIOR SELECTIONS

Designer Appointed Features are home details and finishes curated by the talented design professionals responsible for the distinctive looks found in our Toll Brothers model homes.



1



STUCCO
Shoji White
SW7042

3

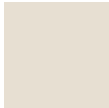

GARAGE DOOR
Shoji White
SW7042

5

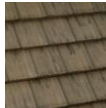

ROOF TILE
Arcadia Canyon Brown
Eagle Ponderosa

7



METAL ROOF
Storm Grey

2



FRONT DOOR
Warm Stone
SW7032

4

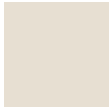

SOFFIT/FASCIA
Shoji White
SW7042

6



ROOF COMP. COLOR
Black Fox
SW7020

PRESERVE AT SAN TAN – PAPAGO COLLECTION | CORDOVA CONTEMPORARY FARMHOUSE
HOME SITE 631 | 3922 W GARDEN GROVE DR | SAN TAN VALLEY, AZ 85142

Prices and offers subject to change without notice. This is not an offering where prohibited by law. Images are for representational purposes only and actual product may differ. Not all images may be shown. See online or onsite sales consultants for details. Listing Broker Toll Brothers Real Estate, Inc. 9/01/22



Designer Appointed Features | STRUCTURAL OPTIONS

Designer Appointed Features are home details and finishes curated by the talented design professionals responsible for the distinctive looks found in our Toll Brothers model homes.

1 MULTI-PANEL POCKET DOOR

026085

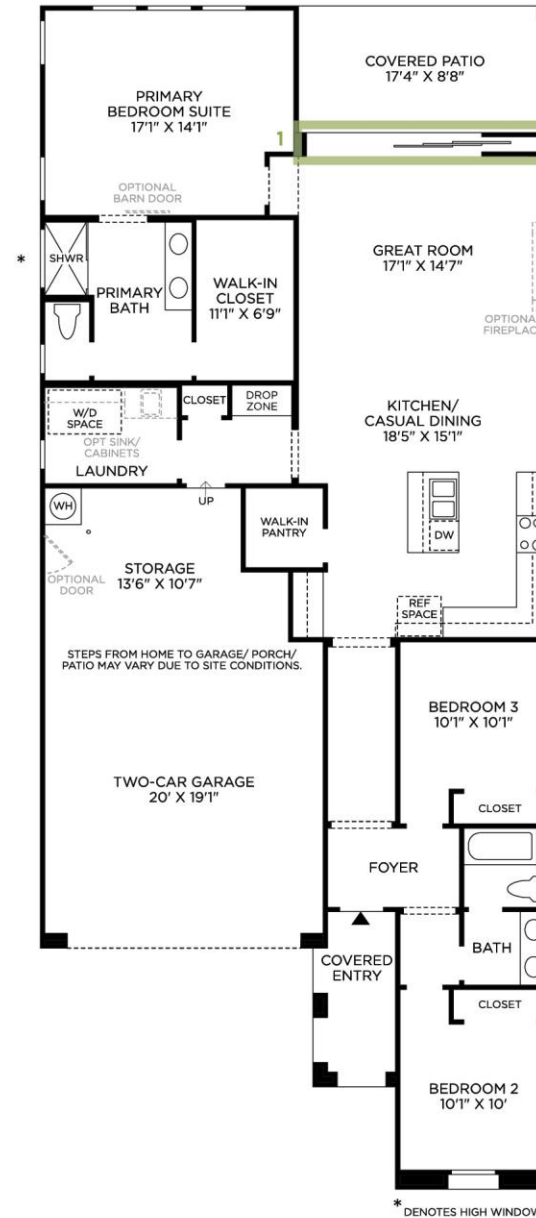

Designer Appointed Features | INCLUDED FEATURES

Designer Appointed Features are home details and finishes curated by the talented design professionals responsible for the distinctive looks found in our Toll Brothers model homes.

ARCHITECTURAL DETAILS

- Elegant floor plans with attractive design choices
- Designer insulated garage doors (per elevation) with opener and keyless entry pad
- Concrete roof tile with choice of colors
- Numerous designer-coordinated exterior color schemes to choose from
- Elegant four-sided exterior detailing
- Front yard landscape package
- Spanish lace stucco finish throughout, including pop-outs
- Oversized covered patios

THOUGHTFULLY DESIGNED INTERIORS

- Dramatic 9' ceilings on first floor
- Ceiling fan pre-wires in great room and primary bedroom where applicable
- Contemporary recessed can lighting
- Energy saving LED lighting throughout home
- Multi-slide pocket door at great room

KITCHEN

- Energy Star qualified appliances by Whirlpool including a 30" freestanding gas range, built-in microwave with hood, and dishwasher
- Elegant crafted maple cabinets with 36" uppers and crown molding in a choice of finishes
- Granite countertops with polished edge and 5" backsplash
- Kohler chrome pull-out spray faucet
- Pre-plumbed for icemaker and reverse osmosis

BATHS

- Spacious primary bedroom suite with walk-in closet
- Lavish primary bath with glass door shower enclosure
- Luxurious 34 ½" adult height vanities
- Kohler 4" centerset chrome faucets

CONVENIENCES

- WiFi Programmable thermostats
- Each home is professionally cleaned prior to settlement
- Pre-wired for advanced communication technology: telephone, cable TV, and computer hook-up

CONSTRUCTION HIGHLIGHTS

- Dual pane, Low-E insulated windows and sliding glass doors
- 14-SEER Bryant high efficiency, ground-mounted air conditioning unit
- Advanced QuickFlash exterior penetration system
- Insulation at interior plumbing walls to reduce sound transfer

QUALITY ASSURANCE AND WARRANTY

- Our quality program starts at design inception with the creation of precise construction drawings, specifying high quality material, all the way through to on-site supervision by experienced project managers and construction managers.
- First home buyer orientation minimum 5-7 days prior to settlement utilizing an extensive checklist
- Second home buyer orientation prior to settlement ensures work has been completed
- Ten-year limited warranty program



Designer Appointed Features | INTERIOR SELECTIONS

Designer Appointed Features are home details and finishes curated by the talented design professionals responsible for the distinctive looks found in our Toll Brothers model homes.

1 WALL PAINT

Sherwin Williams

Alabaster | Wall Ceiling Color | Flat Paint

2 INTERIOR DOORS

Lincoln Smooth Finish

White | Hollow Core – 6'8"

3 INTERIOR DOOR HANDLES

Schlage Halifax

Iron Black | All Interior Doors

4 FLOORING-CARPET

Mohawk Traditional

Tradition | Extended hard surface

5 FLOORING-LUXURY VINYL PLANK

Gemcore Sapphire

Riverton | Extended Hard Surface Areas

1

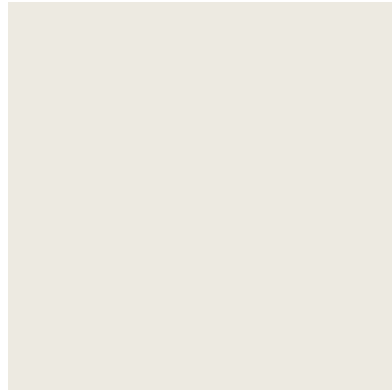

2



3



4



5



Designer Appointed Features | KITCHEN

Designer Appointed Features are home details and finishes curated by the talented design professionals responsible for the distinctive looks found in our Toll Brothers model homes.

1 CABINETS

Timberlake | Shaker Panel

Slate | Kitchen & Remainder of Home

2 HARDWARE

Amerock Edge Pull

Matte Black | For all cabinets

3 COUNTERTOP-ISLAND

Calcatta Maywood Quartz

1.25 inches

4 COUNTERTOP-PERIMETER

Calcatta Maywood Quartz

1.25 inches

5 BACKSPLASH

Calcatta Maywood Quartz

1.25 inches

6 FLOORING-LVP

Gemcore Sapphire

Riverton | Extended Hard Surface Areas

7 FAUCET

Kohler

Purist Semi-Professional | Matte Black

8 SINK

Kohler Whitehaven

White | Cast iron short apron , undermount



1



2



3



4



5



6



7



8

Designer Appointed Features | KITCHEN APPLIANCES

Designer Appointed Features are home details and finishes curated by the talented design professionals responsible for the distinctive looks found in our Toll Brothers model homes.

1 RANGE & OVEN

KitchenAid

Stainless Steel | 30" Gas Convection Slide-in Range

2 MICROWAVE & HOOD

KitchenAid

Stainless Steel | 30" Micro/Hood

3 DISHWASHER

KitchenAid

Stainless Steel | Integrated Dishwasher

1



2



3



Designer Appointed Features | PRIMARY BATHROOM

Designer Appointed Features are home details and finishes curated by the talented design professionals responsible for the distinctive looks found in our Toll Brothers model homes.

1 VANITY CABINETS

Timberlake | Shaker Panel

Slate | Kitchen & Remainder of Home

2 HARDWARE

Amerock | Edge Pull

Matte Black | For all cabinets

3 COUNTERTOP

Cultured Marble White

Square Sink

4 FAUCET

Kohler Hint/Pitch

Chrome | Widespread

5 SINK

Sterling | Square Cultured Marble

White

6 SHOWER - WALL

Cultured Marble 6' Wall

White

7 SHOWER - FLOOR

Fiberglass Pan

White

8 SHOWER FIXTURES

Kohler Pitch

Chrome

9 SHOWER

Frameless Enclosure

Finish ; Matte black | 3/8 inch glass

10 TOILET

Sterling Windham

White | Elongated

11 BATH ACCESSORIES

Kohler BHP Waterfront

Chrome | Towel Bar, Paper Holder, Towel Ring

12 BATH ACCESSORIES

Kohler BHP Waterfront

Chrome | Towel Bar, Paper Holder, Towel Ring



1



2



3



4



5



6



7



8



9



10



11