

Toll Brothers
AMERICA'S LUXURY HOME BUILDER®



PRESERVE AT SAN TAN – PERALTA COLLECTION











Eastover Spanish

HOME SITE 1049 | 3658 W HORSE TRAIL WAY | SAN TAN VALLEY, AZ 85144

Designer Appointed Features | EXTERIOR SELECTIONS

Designer Appointed Features are home details and finishes curated by the talented design professionals responsible for the distinctive looks found in our model homes.



1		PRIMARY Eider White SW 7014	3		FRONT DOOR Gauntlet Gray SW 7019	5		STONE Oakbrook Pro Ledge	7		ROOF Vallejo 2606	9		ROOF ACCENT Well-Bred Brown SW 7027
2		TRIM Black Fox SW 7020	4		GARAGE DOOR Black Fox SW 7020	6		IRON ACCENT Tricorn Black SW 6258	8		SHUTTERS Black Fox SW 7020	10		SOFFIT & FASCIA Black Fox SW 7020

PRESERVE AT SAN TAN | PERALTA COLLECTION | EASTOVER SPANISH
HOME SITE 1049 | 3658 W HORSE TRAIL WAY | SAN TAN VALLEY, AZ 85144

Photographs, renderings, and floor plans are for representational purposes only and may not reflect the exact features or dimensions of your home. All dimensions are subject to field variations. Prices and offers subject to change without notice. This is not an offering where prohibited by law. Images are for representational purposes only and actual product may differ. Not all images may be shown. See online or onsite sales consultants for details.



Designer Appointed Features | STRUCTURAL OPTIONS

Designer Appointed Features are home details and finishes curated by the talented design professionals responsible for the distinctive looks found in our model homes.

- 1 **EXPANDED FAMILY ROOM 4'**
PC023
- 2 **EXPANDED STANDARD COVERED PATIO 4'**
PC027
- 3 **INTERIOR DOUBLE WOOD FRENCH DOORS**
PC166

NOTE:
THIS OPTION EXPANDS THE GREAT ROOM AND CASUAL DINING INSTEAD OF THE FAMILY ROOM ON THIS MODEL.

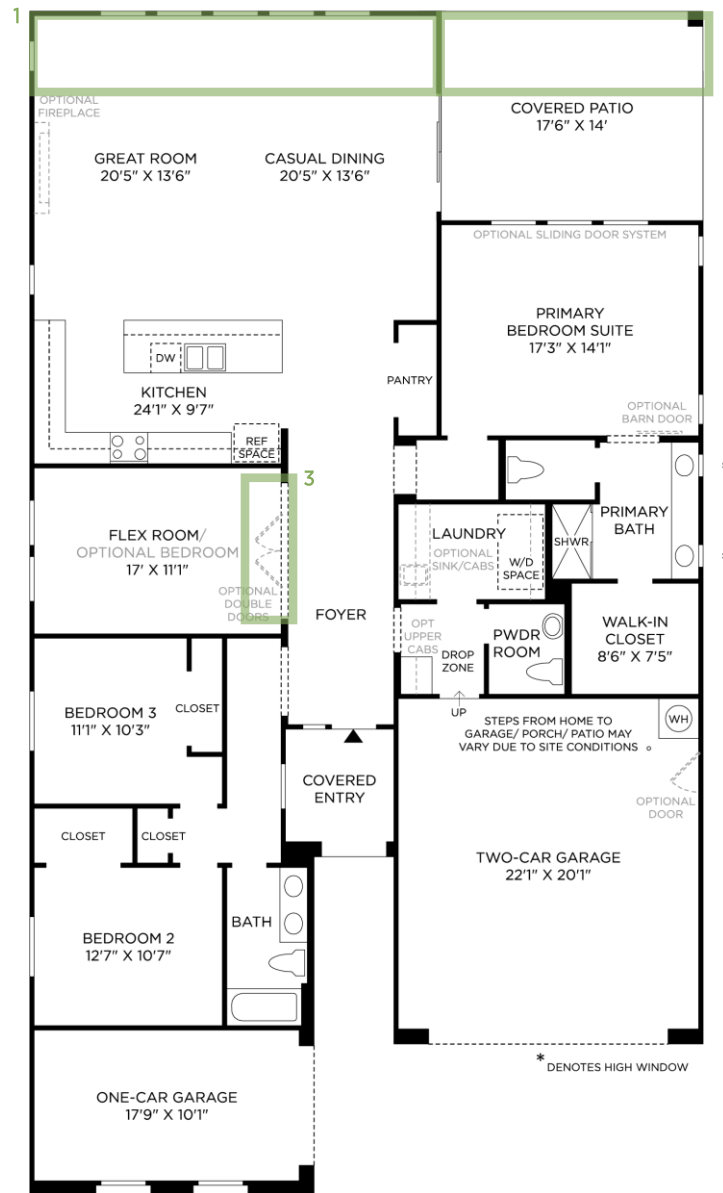

Designer Appointed Features | INTERIOR SELECTIONS

Designer Appointed Features are home details and finishes curated by the talented design professionals responsible for the distinctive looks found in our model homes.

1 WALL PAINT

Sherwin Williams

Alabaster

2 INTERIOR DOORS

Executive Door Co. – Hollow Core

Alabaster | 2 Panel

3 INTERIOR DOOR HANDLES

Kwikset – Tustin

Polished Chrome

4 FLOORING-CARPET

Shaw – Cobble Street

Rock Crystal | 8lb. Pad

5 FLOORING-LVP

Shaw – Polaris Plus

Feather Gray

6 FLOORING-BATH TILE

Arizona Tile - Cosmic

White | 12x24 33% Stairstep

1

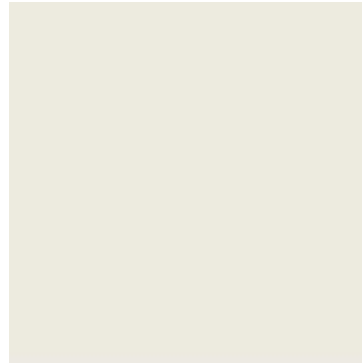

2



3



4

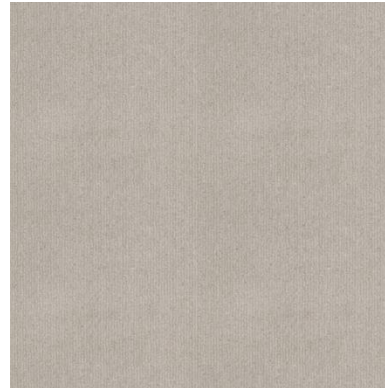

5



6



Designer Appointed Features | KITCHEN

Designer Appointed Features are home details and finishes curated by the talented design professionals responsible for the distinctive looks found in our model homes.

1 CABINETS - ISLAND

Timberlake - Barnett

Maple Slate | Standard Overlay

2 CABINETS - PERIMETER

Timberlake - Barnett

Painted Stone | Standard Overlay

3 COUNTERTOP

Arizona Tile - Quartz

New Venatino Gray | 1 ½" Edge

4 BACKSPLASH

Arizona Tile - Flash

Glossy White | 3x12 Herringbone

5 FLOORING-LVP

Shaw - Polaris Plus

Feather Gray

6 SINK

Kohler - Vault

Stainless | Single Bowl Undermount

7 FAUCET

Kohler - Jolt

Polished Chrome

1



2



3



4

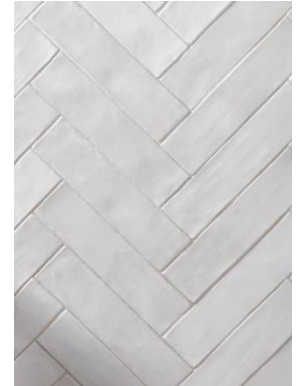

5



6



7



Designer Appointed Features | KITCHEN APPLIANCES

Designer Appointed Features are home details and finishes curated by the talented design professionals responsible for the distinctive looks found in our model homes.

1 RANGE/OVEN

Whirlpool

Stainless/Black | 5 Cu. Ft. Gas Range with Storage

2 MICROWAVE/VENT HOOD

Whirlpool

Stainless/Black | 1.9 Cu. Ft. Over the Range

3 DISHWASHER

Whirlpool

Stainless/Black | Built In

1



3

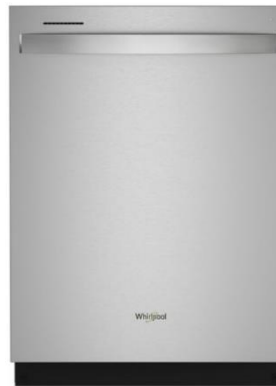

2



Designer Appointed Features | POWDER ROOM

Designer Appointed Features are home details and finishes curated by the talented design professionals responsible for the distinctive looks found in our model homes.

1 PEDESTAL SINK

Kohler – Sacramento

White | 21in

2 FAUCET

Kohler - Bellera

Polished Chrome | Widespread

3 TOILET

Kohler - Highline

White | Comfort Height

4 FLOORING-LVP

Shaw - Polaris Plus

Feather Gray

5 BATH ACCESSORIES

Kohler - Bellera

Polished Chrome

1



2



3



4



5



Designer Appointed Features | PRIMARY BATHROOM

Designer Appointed Features are home details and finishes curated by the talented design professionals responsible for the distinctive looks found in our model homes.

1 VANITY CABINETS

Timberlake - Barnett

Painted Stone | Standard Overlay

2 COUNTERTOP & SINK

Cultured Marble

White | Square Sinks

3 FAUCET

Kohler - Bellera

Polished Chrome | Widespread

4 SHOWER TILE—WALLS

Arizona Tile - Gioia

Glossy Ash | 4x16 50% Stagger

5 SHOWER TILE—FLOOR

Arizona Tile - Cosmic

White | 2x2 Mosaic

6 SHOWER FIXTURES

Kohler - Bellera

Polished Chrome

7 TOILET

Kohler - Highline

White | Comfort Height

8 BATH ACCESSORIES

Kohler - Bellera

Polished Chrome

1



2



3



4



5



6



7



8



9

10

Designer Appointed Features | SECONDARY BATHROOM

Designer Appointed Features are home details and finishes curated by the talented design professionals responsible for the distinctive looks found in our model homes.

1 VANITY CABINETS

Timberlake - Barnett

Painted Stone | Standard Overlay

2 COUNTERTOP & SINK

Cultured Marble

White | Square Sinks

3 FAUCET

Kohler - Bellera

Polished Chrome | Widespread

4 SHOWER SURROUNDS

Medley Walls

White

5 TUB

Kohler - Ensemble

White | 5'

6 SHOWER FIXTURES

Kohler - Bellera

Polished Chrome

7 TOILET

Kohler - Highline

White | Comfort Height

8 BATH ACCESSORIES

Kohler - Bellera

Polished Chrome

1



2



3



4



5



6



7



8

