

Toll Brothers
AMERICA'S LUXURY HOME BUILDER®



TOLL BROTHERS AT SEMINOLE ISLE







Aloma Coastal

HOME SITE 17 | 9975 KEY HAVEN RD | SEMINOLE, FL 33777

Designer Appointed Features | EXTERIOR SELECTIONS

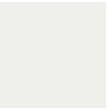
Designer Appointed Features are home details and finishes curated by the talented design professionals responsible for the distinctive looks found in our model homes.

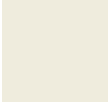

1		BOARD & BATTEN Dover White SW 6385	3		FRONT DOOR Stardew SW 9138	5		WINDOWS White
2		STUCCO Buff SW 7683	4		GARAGE DOOR Dover White SW 6385	6		SHUTTERS Stardew SW 9138

TOLL BROTHERS AT SEMINOLE ISLE | ALOMA COASTAL
HOME SITE 17 | 9975 KEY HAVEN RD | SEMINOLE, FL 33777

Photographs, renderings, and floor plans are for representational purposes only and may not reflect the exact features or dimensions of your home; actual product may differ. All dimensions are subject to field variations. Prices and offers subject to change without notice. This is not an offering where prohibited by law. Not all images may be shown. See online or onsite Sales Consultants for details.



Designer Appointed Features | ARCHITECTURAL SELECTIONS

Designer Appointed Features are home details and finishes curated by the talented design professionals responsible for the distinctive looks found in our model homes.

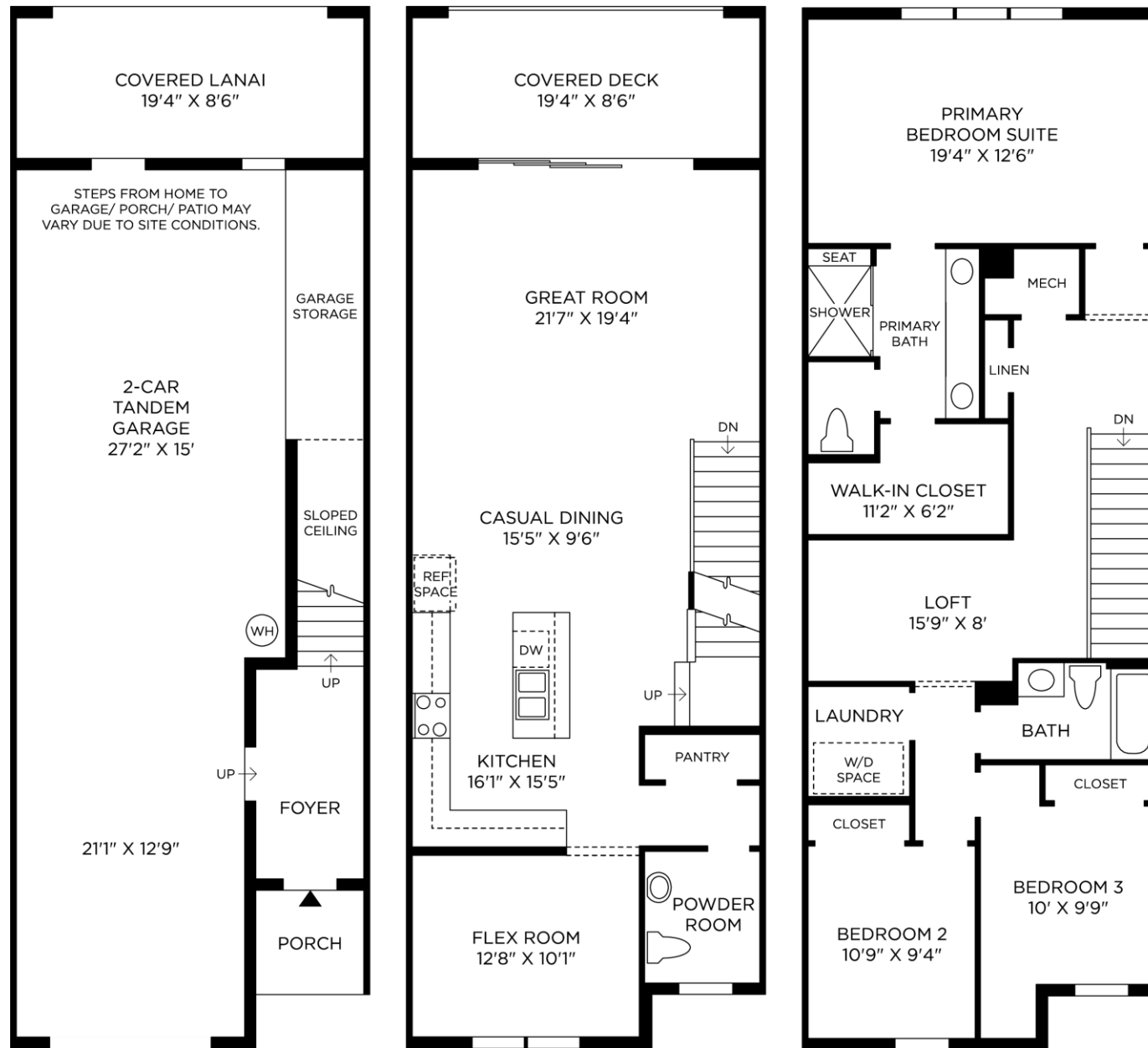

Designer Appointed Features | EXTERIOR SELECTIONS

Designer Appointed Features are home details and finishes curated by the talented design professionals responsible for the distinctive looks found in our model homes.

1 SIDING

Manufacturer Product

Color	Size or Description
Blue	Small
Red	Medium
Green	Large
Yellow	Extra Large

2 BOARD AND BATTEN

Manufacturer Product

Color	Size or Description
Blue	Small
Red	Medium
Green	Large
Yellow	Extra Large

3 TRIM

Manufacturer Product

Color	Size or Description
Blue	Small
Red	Medium
Green	Large
Yellow	Extra Large
Purple	Very Large
Pink	Small
Orange	Medium
Brown	Large
Grey	Extra Large
White	Very Large

4 ROOF

Manufacturer Product

[illegible]

5 METAL ROOF

Manufacturer Product

Color	Size or Description
Blue	Small
Red	Medium
Green	Large
Yellow	Extra Large

6 STONE

Manufacturer Product

[illegible]

7 WINDOWS

Manufacturer Product

Color	Size or Description
Blue	Small
Red	Medium
Green	Large
Yellow	Extra Large

8 GARAGE

Manufacturer Product

Color | Size or Description

9 FRONT DOOR

Manufacturer Product

Color	Size or Description
Blue	Small
Red	Medium
Green	Large
Yellow	Extra Large

1

2

3

4

5

6

7

8

9



Designer Appointed Features | INTERIOR FEATURES WITH EXTERIOR HARDWARE

Designer Appointed Features are home details and finishes curated by the talented design professionals responsible for the distinctive looks found in our model homes.

1 EXTERIOR HANDLESET

Kwikset San Clemente

Matte Black | 916 ZW Contemporary Smart Deadbolt

2 INTERIOR HANDLESET

Kwikset Halifax Lever

Matte Black

3 INTERIOR DOORS

Masonite

White | 2-Panel Square

4 INTERIOR PAINT – WALLS & CEILING

Sherwin Williams

Pure White | Flat

5 INTERIOR PAINT – TRIM

Sherwin Williams

Extra White | Semi-Gloss

6 LVP – MAIN LIVING & ALL BEDROOMS

Shaw TB Pride Plus

Riverside

1



2



3



4

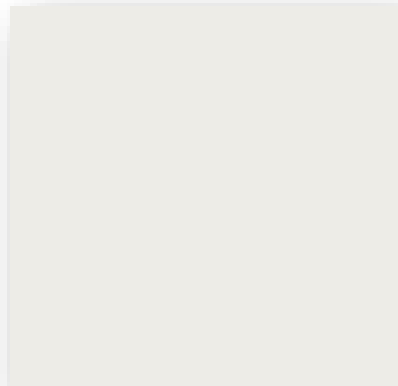

5

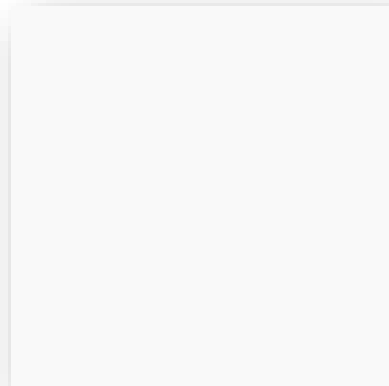

6



Designer Appointed Features | INTERIOR FEATURES WITH EXTERIOR DOOR HARDWARE

Designer Appointed Features are home details and finishes curated by the talented design professionals responsible for the distinctive looks found in our model homes.

1 LVP – 2ND FLOOR BEDROOMS AND LOFT

Shaw TB Pride Plus
Riverside

2 STAIR BALUSTERS

5060 Painted White Spindles
Paint: SW 7006 Extra White

3 NEWEL POST

4010G Modern Newel
Stain: Ebony

4 HANDRAIL

684 Handrail
Stain: Ebony

5 TREADS

Stained Red Oak with Painted Risers
Stain: Ebony | Paint: SW 7006 Extra White

6 STAIN COLOR

Ebony

1



2

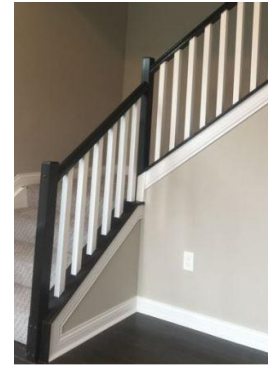

3



4

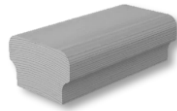

5



6

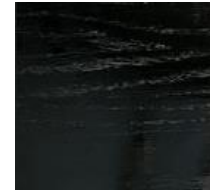

Design Elements | OPTIONAL WHIRLPOOL BUILT-IN ELECTRIC

Designer Appointed Features are home details and finishes curated by the talented design professionals responsible for the distinctive looks found in our model homes.

36" ELECTRIC COOKTOP, COMBO OVEN, HOOD, DISHWASHER

Phase 1 Option # PC112991

Phase 2 Option # APKK2005

(Envision APKK2005-1)

- 1 **36" CONVERTIBLE UNDER-CABINET HOOD** UXT5536AAS
 - 400 CFM exhaust rating
 - Dual-halogen worksurface
- 2 **36" ELECTRIC CERAMIC GLASS COOKTOP WITH DUAL RADIANT ELEMENT** WCE55US6HB
 - Easy-wipe ceramic glass cooktop
 - Warm zone element
 - 5-element cooktop
- 3 **COMBO WALL OVEN WITH AIR FRY WHEN CONNECTED—SMART WALL OVEN** WOEC5030LZ
 - 6-in-1 wall oven with fan convection
 - 6.4 cu. ft. total capacity
 - Air-fry mode when connected
 - Automatic feature updates when connected
- 4 **LARGE-CAPACITY DISHWASHER WITH THIRD RACK** WDT751SAPZ
 - 47 dBA
 - Stainless steel tub—5 cycles
 - 5 options
 - Top control



1



2



3

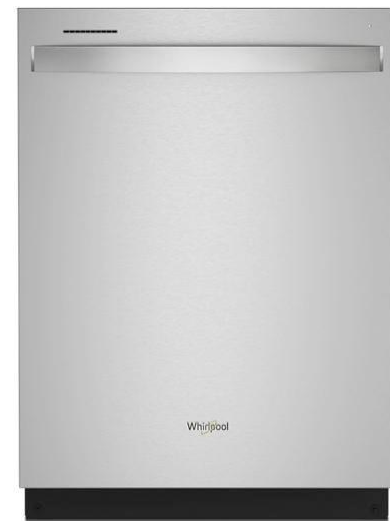

4



Designer Appointed Features | KITCHEN

Designer Appointed Features are home details and finishes curated by the talented design professionals responsible for the distinctive looks found in our model homes.

1 CABINETS - PERIMETER

Mid-Continent Dapper

Thatch - Full Overlay with Soft Close Drawers and Doors

2 CABINETS - ISLAND

Mid-Continent Dapper

Painted White- Full Overlay with Soft Close Doors

3 CABINETS HARDWARE

Top Knobs Hopewell Bar Pull

Flat Black

4 COUNTERTOP

Perimeter: MSI Quartz

Carrara Breve | 3 cm

Island: MSI Dolomite

Fantasy Brown Leathered | 3 cm

5 BACKSPLASH

Daltile Mesmerist

Trance | 3x12

6 FLOORING-ENGINEERED WOOD

Anderson Worthing II

Holland Park

7 FAUCET

Kohler Crue

Matte Black | Pull-Down

8 SINK

Sterling McAllister

Stainless Steel | Single Bowl Undermount

1



2

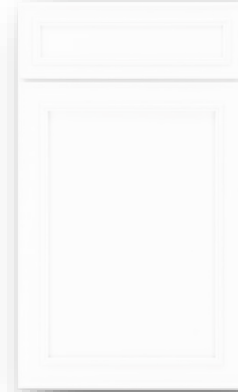

3



4



5



6



7

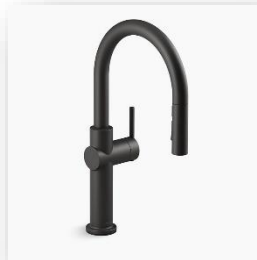

8



Designer Appointed Features | PRIMARY BATHROOM

Designer Appointed Features are home details and finishes curated by the talented design professionals responsible for the distinctive looks found in our model homes.

1 CABINETRY

Mid-Continent Dapper

Thatch | Full Overlay with Soft Close Doors

2 CABINETRY HARDWARE

Top Knobs Hopewell Bar Pull

Flat Black

3 COUNTERTOP

MSI Quartz

Carrara Breve | 3cm

4 VANITY FAUCET

Kohler Hint

Matte Black | Single Handle

5 VANITY SINK

Kohler Caxton Rectangle

White | Undermount

6 TILE - FLOOR & SHOWER WALL

Floor: Marazzi Moroccan

Concrete

Off White | 8" Hexagon

Wall: Daltile Mesmerist

Trance | 3x12

7 SHOWER FLOOR - SHOWER PAN

Kohler Rely

White | 60"X42"

8 SHOWER ONLY FAUCET

Kohler Pitch

Matte Black

9 TOILET

Kohler Wellworth

White | Elongated

1



2



3



4



5



6



7



8

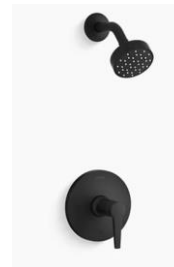

9



Designer Appointed Features | BATHROOM # 2

Designer Appointed Features are home details and finishes curated by the talented design professionals responsible for the distinctive looks found in our model homes.

1 CABINETRY

Mid-Continent Dapper

Thatch | Full Overlay with Soft Close Doors

2 CABINETRY HARDWARE

Top Knobs Hopewell Bar Pull

Flat Black

3 COUNTERTOP

MSI Quartz

Carrara Breve | 3cm

4 VANITY FAUCET

Kohler Hint

Matte Black | Single Handle

5 VANITY SINK

Kohler Caxton Rectangle

White | Undermount

6 TILE - FLOORING & SHOWER WALL

Floor: Marazzi Moroccan

Concrete

Off White | 8" Hexagon

Wall: Daltile Color Wheel Matte

Biscuit | 3x6

7 TUB/SHOWER FAUCET

Kohler Pitch

Matte Black

8 TUB

Sterling Ensemble

White | 60"x30"

9 TOILET

Kohler Wellworth

White | Elongated

1



2



3



4



5



6



7

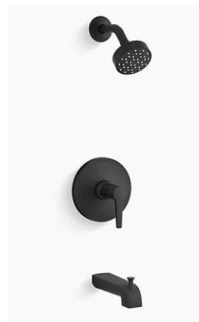

8



9



Designer Appointed Features | POWDER ROOM

Designer Appointed Features are home details and finishes curated by the talented design professionals responsible for the distinctive looks found in our model homes.

1 PEDESTAL SINK

Kohler Veer
White | Single Handle

2 FAUCET

Kohler Hint
Matte Black | Single Handle

3 TOILET

Kohler Wellworth
White | Elongated

4 FLOORING - TILE

Marazzi Moroccan Concrete
Off White | 8" Hexagon



1



2



3



4