

*Toll Brothers*  
AMERICA'S LUXURY HOME BUILDER®



REGENCY AT ESPERANZA | ZAMBRA COLLECTION







# Ridge Transitional

HOME SITE #18 | 301 MIRAVAL | BOERNE, TX 78006

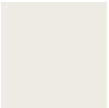
# Designer Appointed Features | EXTERIOR SELECTIONS

Designer Appointed Features are home details and finishes curated by the talented design professionals responsible for the distinctive looks found in our model homes.

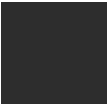
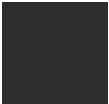

1		<b>STUCCO</b> Snowbound SW 7004	3		<b>FRONT DOOR</b> Charcoal Traditional	5		<b>WINDOWS</b> White	7		<b>ROOF</b> Weathered Wood Gaf
2		<b>TRIM</b> Tricorn Black SW 6258	4		<b>GARAGE DOOR</b> Tricorn Black SW 6258	6		<b>GUTTERS</b> Black			

REGENCY AT ESPERANZA | ZAMBRA COLLECTION | RIDGE TRANSITIONAL  
HOME SITE #18 | 301 MIRAVAL | BOERNE, TX 78006

Photographs, renderings, and floor plans are for representational purposes only and may not reflect the exact features or dimensions of your home; actual product may differ. All dimensions are subject to field variations. Prices and offers subject to change without notice. This is not an offering where prohibited by law. Not all images may be shown. See online or onsite Sales Consultants for details.



## Designer Appointed Features | ARCHITECTURAL SELECTIONS

Designer Appointed Features are home details and finishes curated by the talented design professionals responsible for the distinctive looks found in our model homes.

- 1 EXTENDED PRIMARY CLOSET
- 2 MULTI-SLIDE STACKED DOOR
- 3 TRADITIONAL FIREPLACE 42" NOVUS
- 4 LAUNDRY ROOM U/M SINK
- 5 PRI BATH 1.75 HANDSHOWER  
(not shown)
- 6 SEC BATH - SHOWER STALL W/ TILE FLOOR  
(not shown)

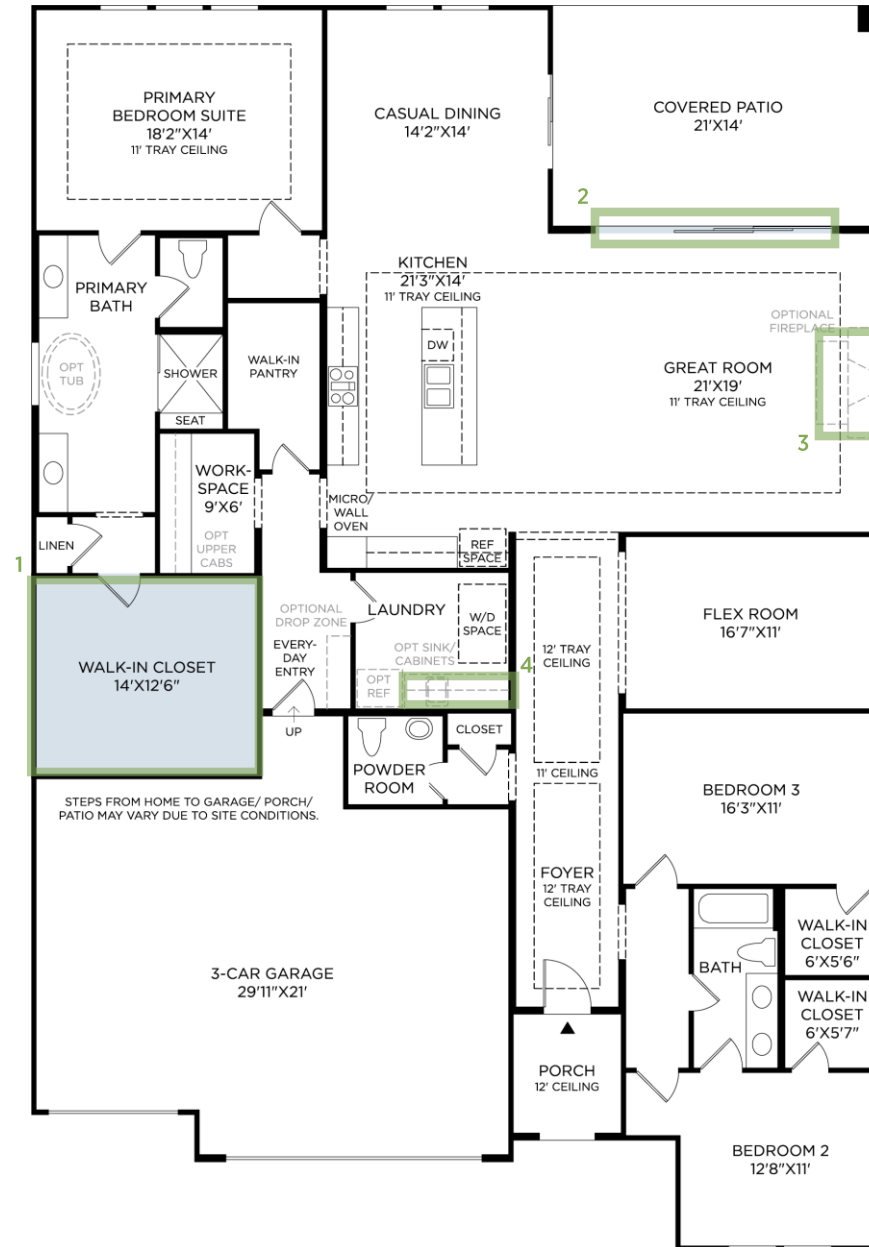

# Designer Appointed Features | INTERIOR SELECTIONS

Designer Appointed Features are home details and finishes curated by the talented design professionals responsible for the distinctive looks found in our model homes.

## 1 WALL PAINT

**Sherwin Williams**

Extra White | SW7006

## 2 INTERIOR DOORS

**2 Panel Square**

Extra White | SW7006

## 3 INTERIOR DOOR HANDLES

**Kwikset Ladera**

Satin Nickel | Levers

## 4 FLOORING-CARPET

**Shaw Stone Path**

Weathered

## 5 FLOORING-TILE

**Arizona Tile - Aequa**

Nix Matte | 8x32

## 6 FIREPLACE

**Cast Stone - Manhattan**

Smooth Delicate White

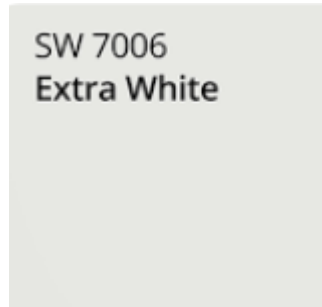

1



2



3



4



5



6

# Designer Appointed Features | KITCHEN

Designer Appointed Features are home details and finishes curated by the talented design professionals responsible for the distinctive looks found in our model homes.

## 1 CABINETS-PERIMETER

**Kent Moore**

Extra White | Groveland 18

## 2 CABINETS-ISLAND

**Kent Moore**

Nebulous Gray | Groveland 18

## 3 COUNTERTOP

**Arizona Tile**

Vallejo Gold | 3CM Straight

## 4 BACKSPLASH

**Daltile - Color Wheel**

Arctic White Glossy | 3x6

## 5 FLOORING-TILE

**Arizona Tile - Aequa**

Nix Matte | 8x32

## 6 FAUCET

**Kohler Graze**

Vibrant Stainless | Single Hole

## 7 SINK

**Kohler Vault**

Stainless Steel | Single Basin Undermount

1



2



3



4

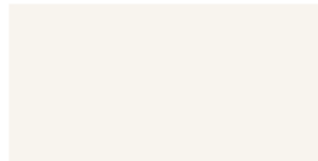

5



6



7



# Designer Appointed Features | KITCHEN APPLIANCES

Designer Appointed Features are home details and finishes curated by the talented design professionals responsible for the distinctive looks found in our model homes.

## 1 VENT HOOD

KitchenAid 36" Under-Cabinet Hood

Stainless Steel

## 2 COOKTOP

KitchenAid 36" Gas Cooktop

Stainless Steel

## 3 WALL OVEN

KitchenAid 30" Combination Wall Oven/Microwave

Stainless Steel

## 4 DISHWASHER

KitchenAid 24" Dishwasher

Stainless steel



1



2



3



4

# Designer Appointed Features | WORKSPACE

Designer Appointed Features are home details and finishes curated by the talented design professionals responsible for the distinctive looks found in our model homes.

## 1 CABINETS

### Kent Moore

Extra White | Groveland 18

## 2 COUNTERTOP

### Arizona Tile

Vallejo Gold | 3CM Straight

## 3 FLOORING-TILE

### Arizona Tile - Aequa

Nix Matte | 8x32

1



2



3



# Designer Appointed Features | PRIMARY BATH

Designer Appointed Features are home details and finishes curated by the talented design professionals responsible for the distinctive looks found in our model homes.

## 1 CABINETS

**Kent Moore**

Extra White | Groveland 18

## 2 COUNTERTOP

**Silestone**

Blanco Maple | 2CM Straight

## 3 FAUCET

**Sterling Medley**

Brushed Nickel | Centerset

## 4 SINK

**Kohler Caxton**

White | Rectangular Undermount

## 5 SHOWER TILE-WALLS

**Arizona Tile - Shibusa**

Bianco | 12x24 Matte

## 6 TILE—FLOOR

**Arizona Tile – Aequa**

Nix Matte | 8x32

## 7 SHOWER FIXTURES

**Sterling Medley**

Brushed Nickel

## 8 TOILET

**Kohler Highline Elongated**

White | Comfort Height

## 9 BATH ACCESSORIES

**Kohler Simplice**

Brushed Nickel

1



2



3



4



5



6



7



8



9



# Designer Appointed Features | HALL BATH

Designer Appointed Features are home details and finishes curated by the talented design professionals responsible for the distinctive looks found in our model homes.

## 1 CABINETS

### Kent Moore

Extra White | Groveland 18

## 2 COUNTERTOP

### Granite

Blanco Galia | 2CM Straight

## 3 FAUCET

### Sterling Medley

Polished Chrome | Centerset

## 4 SINK

### Kohler Caxton

White | Rectangular Undermount

## 5 SHOWER TILE-WALLS

### Arizona Tile - Shibusa

Bianco | 12x24 Matte

## 6 TILE—FLOOR

### Arizona Tile – Aequa

Nix Matte | 8x32

## 7 SHOWER FIXTURES

### Sterling Medley

Polished Chrome

## 8 TOILET

### Kohler Highline Elongated

White | Comfort Height

## 9 BATH ACCESSORIES

### Moen

Polished Chrome

1



2



3



4



5



6



7

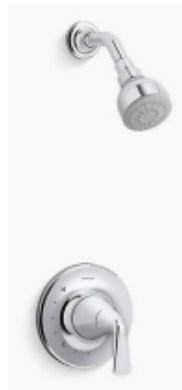

8



9



# Designer Appointed Features | LAUNDRY

Designer Appointed Features are home details and finishes curated by the talented design professionals responsible for the distinctive looks found in our model homes.

## 1 CABINETS

**Kent Moore**

Grey Wolf | Groveland 18

## 2 COUNTERTOP

**Granite**

Blanco Galia | 2CM Straight

## 3 FAUCET

**Kohler Jolt**

Polished Chrome | Centerset

## 4 SINK

**Sterling Latitude**

White | Undermount

## 5 FLOORING-TILE

**Emser Tile – Brook II**

White Matte | 13x13



1



2



3



4

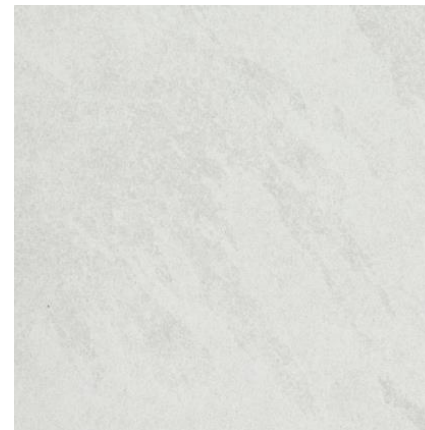

5