

Toll Brothers
AMERICA'S LUXURY HOME BUILDER®



GRIFFITH LAKES | PRESERVE COLLECTION

Nayan Modern Farmhouse

HOME SITE #336 | 7113 FOWLEY RD. | CHARLOTTE, NC 28269

Designer Appointed Features | EXTERIOR SELECTIONS

Designer Appointed Features are home details and finishes curated by the talented design professionals responsible for the distinctive looks found in our model homes.



1		PRIMARY Gray Matters SW 7066	3		FRONT DOOR Charcoal Blue SW 2739	5		PAINTED BRICK Passive SW 7064	7		ROOF Charcoal
2		TRIM Pure White SW 7005	4		GARAGE DOOR White	6		FASCIA Snow CertainTeed	8		WINDOWS White



Designer Appointed Features | ARCHITECTURAL SELECTIONS

Designer Appointed Features are home details and finishes curated by the talented design professionals responsible for the distinctive looks found in our model homes.

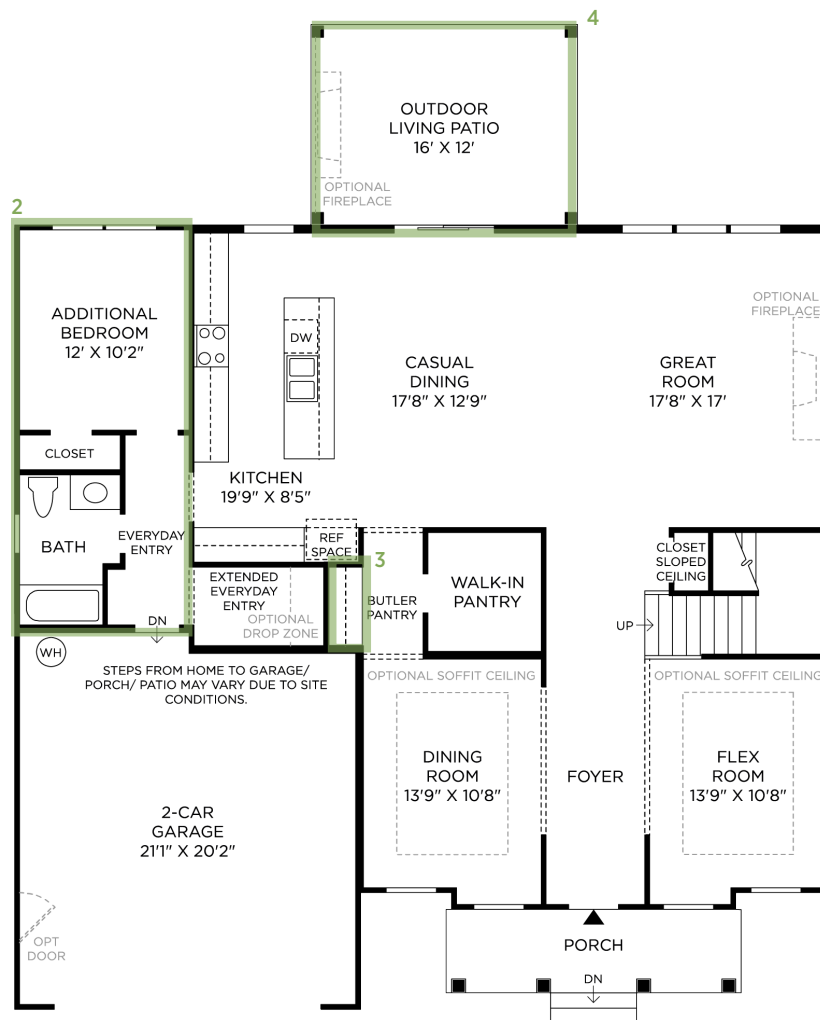

- ## 1 OPEN RAILING

PC201 (not shown)

- ### 3 BUTLER PANTRY

PC812

- ## 5 LAUNDRY ROOM UTILITY SINK

PC047174

- ## 7 TRAY CEILING

PC036487

- ## 2 BEDROOM REPLACES OFFICE

PC263367

- #### 4 OUTDOOR LIVING AREA

PC263165

- ## 6 TANKLESS WATER HEATER

PC047190 (not shown)

- ## 8 OAK STAIR WITH PAINTED RISER

PC036462 (not shown)

- ## 9 PRIMARY BATH 1.75 HANDSHOWER

PC049198 (not shown)

GRIFFITH LAKES | PRESERVE COLLECTION | NAYAN MODERN FARMHOUSE
 HOME SITE 336 | 7113 FOWLEY RD | CHARLOTTE, NC 28269

Photographs, renderings, and floor plans are for representational purposes only and may not reflect the exact features or dimensions of your home; actual product may differ. All dimensions are subject to field variations. Prices and offers subject to change without notice. This is not an offering where prohibited by law. Not all images may be shown. See online or onsite Sales Consultants for details.



Designer Appointed Features | KITCHEN

Designer Appointed Features are home details and finishes curated by the talented design professionals responsible for the distinctive looks found in our model homes.

1 CABINETS - PERIMETER

Timberlake Sonoma
Painted Harbor | Level 2

2 CABINETS - ISLAND

Timberlake Sonoma
Painted Boulder | Level 2

3 COUNTERTOP- PERIMETER & ISLAND

MSI
Calacutta Ultra | Level 3

4 BACKSPLASH

Daltile Mythology Wavecrest
Santorini | Horizontal Stack

5 FLOORING

Shaw Luxury Vinyl Plank
House - Hearthstone Gray

6 FAUCET

Kohler Bellera
Vibrant Stainless | K-560-VS

7 SINK

Kohler Vault
Stainless U/M Single Bowl | K-3821-NA-SS

8 LIGHTING-ISLAND

Progress Lighting
Atwell Pendants - Brushed Nickel

9 HARDWARE

Timberlake
Satin Nickel | Pull - 4213SN



1



2

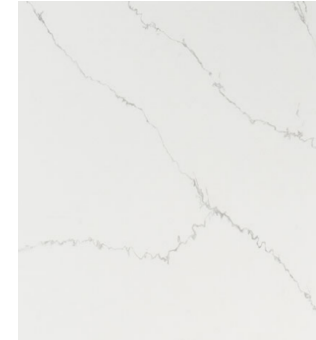

3



4



5



6



7



8



9

Designer Appointed Features | BUTLER'S PANTRY

Designer Appointed Features are home details and finishes curated by the talented design professionals responsible for the distinctive looks found in our model homes.

1 CABINETS - PERIMETER & ISLAND

Timberlake Sonoma
Painted Harbor | Level 2

2 HARDWARE

Timberlake
Satin Nickel | Pull - 4213SN

3 COUNTERTOP- PERIMETER & ISLAND

MSI Quartz
Calacatta Ultra | Level 3

4 BACKSPLASH

Daltile Mythology Wavecrest
Santorini | 4x12 Horizontal Stack

5 FLOORING

Shaw Luxury Vinyl Plank
Home | Hearthstone Gray



Designer Appointed Features | KITCHEN APPLIANCES

Designer Appointed Features are home details and finishes curated by the talented design professionals responsible for the distinctive looks found in our model homes.

1 COOKTOP

Whirlpool
Stainless Steel | 36" 5-Burner Gas

2 VENT HOOD

Whirlpool
Stainless Steel | 36" Under Cabinet

3 MICROWAVE/OVEN COMBO

Whirlpool
Stainless Steel

4 DISHWASHER

Whirlpool
Stainless Steel

5 REFRIGERATOR

Whirlpool
Stainless Steel – Side By Side

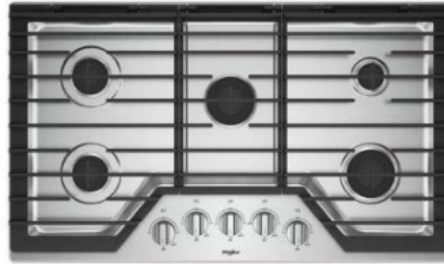

1



2



3



4



5

Designer Appointed Features | PRIMARY BATHROOM

Designer Appointed Features are home details and finishes curated by the talented design professionals responsible for the distinctive looks found in our model homes.

1 VANITY CABINETS

Timberlake Sonoma
Painted Harbor | Level 2

2 HARDWARE

Timberlake
Satin Nickel | Pull 4213SN

3 COUNTERTOP

MSI
Calacutta Ultra

4 FAUCET

Kohler Venza
Brushed Nickel | Widespread

5 SINK

Caxton
White | Rectangle

6 SHOWER TILE—WALLS

Daltile Color Wheel Gloss
Desert Gray | 4x16

7 SHOWER TILE—FLOOR

American Olean Montesano
White | 2x5 Chevron

8 SHOWER FIXTURES

Kohler Venza
Brushed Nickel

9 FREESTANDING TUB

Kohler
Sunstruck | White

10 TILE - FLOOR

American Olean Montesano
White | 15x30 1/3 Offset

11 TOILET

Sterling Windham
White | Comfort Height

12 LIGHTING

Progress Replay
Brushed Nickel



1



2

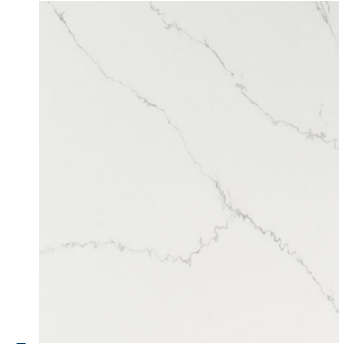

3



4



5

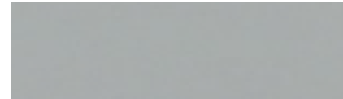

6



7



8



9

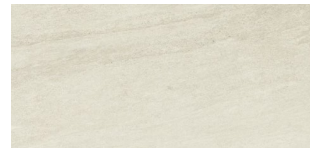

10



11



12

Designer Appointed Features | FIRST FLOOR BATHROOM

Designer Appointed Features are home details and finishes curated by the talented design professionals responsible for the distinctive looks found in our model homes.

1 VANITY CABINETS

Timberlake Sonoma
Painted Harbor | Level 2

2 HARDWARE

Timberlake
Polished Chrome | Pull 4213PC

3 COUNTERTOP

Silestone
Blanco Maple

4 FAUCET

Sterling Medley
Polished Chrome | 4" Centerset

5 SINK

Caxton
White | Oval

6 SHOWER TILE—WALLS

Daltile Color Wheel
Arctic White Matte | 3x6 Horizontal Brick

7 TOILET

Sterling Windham
White Standard Height

8 SHOWER FIXTURES

Sterling Medley
Polished Chrome

9 BATH ACCESSORIES

Pamex
Polished Chrome | Seal Beach

10 TILE - FLOOR

American Olean Montesano
White | 15x30 1/3 Offset

11 TILE - SHOWER FLOOR

Daltile Color Wheel
Arctic White Matte | 1.5" Hex Mosaic



1



2



3



4



5

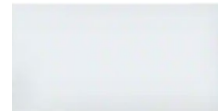

6



7

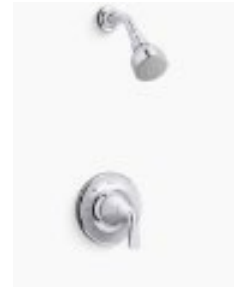

8



9

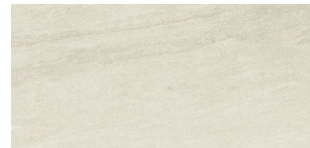

10



11

Designer Appointed Features | UP HALL BATH & BATH @ BDRM 4

Designer Appointed Features are home details and finishes curated by the talented design professionals responsible for the distinctive looks found in our model homes.

1 VANITY CABINETS

Timberlake Sonoma
Painted Harbor | Level 2

2 HARDWARE

Timberlake
Polished Chrome | Pull 4213PC

3 COUNTERTOP

Silestone
Blanco Maple

4 FAUCET

Kohler Medley
Polished Chrome | 4" Centerset

5 SINK

Caxton
White | Oval

6 TUB TILE—WALLS

Daltile Color Wheel
Arctic White Matte | 3x6 Horizontal Brick

7 TOILET

Sterling Windham
White Standard Height

8 TUB/SHOWER FIXTURES

Sterling Medley
Polished Chrome

9 BATH ACCESSORIES

Pamex
Polished Chrome | Seal Beach

10 TILE - FLOOR

American Olean Montesano
White | 15x30 1/3 Offset



1



2



3



4



5



6



7

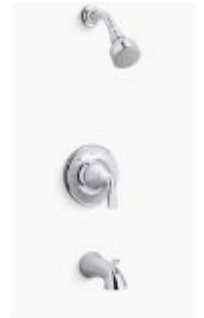

8



9

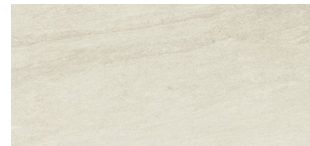

10

Designer Appointed Features | FLOORING AND PAINT COLOR

Designer Appointed Features are home details and finishes curated by the talented design professionals responsible for the distinctive looks found in our model homes.

- 1 HARDWOOD FLOORING**
Shaw Luxury Vinyl Plank
House Hearthstone Gray
- 2 CARPET (LOFT ONLY)**
Shaw
Sea Grove Key | Mist
- 3 CARPET (ALL OTHER CARPETED AREAS)**
Shaw
Enchanted Vision | Silver Mist
- 4 Sherwin Williams**
Extra White | SW

