

*Toll Brothers*  
AMERICA'S LUXURY HOME BUILDER®



568 WEST

# Fawcett Manchester

HOME SITE 11 | 519 MOTIVATION CIRCLE NW | ATLANTA, GA 30309



# Designer Appointed Features | EXTERIOR SELECTIONS

Designer Appointed Features are home details and finishes curated by the talented design professionals responsible for the distinctive looks found in our model homes.



1



## PRIMARY

Olympus White  
SW 6253

2

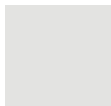

## TRIM

Ice Cube  
SW 6252

3



## FRONT DOOR

Cloak Gray  
SW 6278

4



## GARAGE DOOR

Truly Taupe  
SW 6038

5

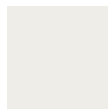

## WINDOWS

White

6



## BAYS & PANNELS

Lazy Gray  
SW 6254

568 WEST | FAWCETT MANCHESTER  
HOME SITE 11 | 519 MOTIVATION CIRCLE NW | ATLANTA, GA 30309

Photographs, renderings, and floor plans are for representational purposes only and may not reflect the exact features or dimensions of your home; actual product may differ. All dimensions are subject to field variations. Prices and offers subject to change without notice. This is not an offering where prohibited by law. Not all images may be shown. See online or onsite Sales Consultants for details.



# Designer Appointed Features | ARCHITECTURAL SELECTIONS

Designer Appointed Features are home details and finishes curated by the talented design professionals responsible for the distinctive looks found in our model homes.

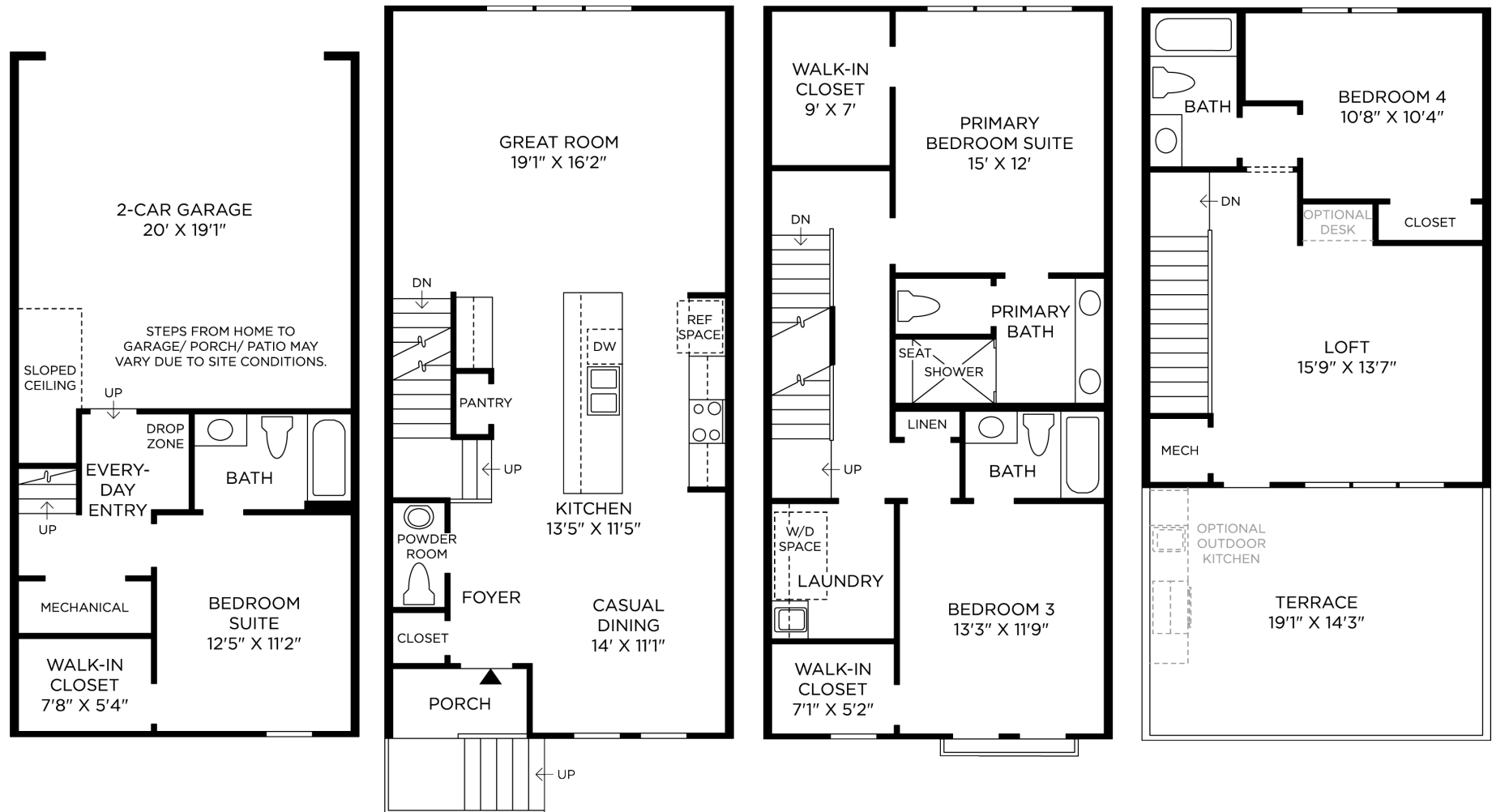

## 1 DRY BAR

PC132485 (not shown)

## 2 ELECTRIC FIREPLACE 50" ALLUSION PLTNM

PC106262 (not shown)

## 3 SEC BATH - SHOWER STALL W/ TILE FLOOR

PC048644 (not shown)

# Designer Appointed Features | EXTERIOR SELECTIONS

Designer Appointed Features are home details and finishes curated by the talented design professionals responsible for the distinctive looks found in our model homes.

- 1 EXPOSED FOUNDATION WALL**  
**FIBER CEMENT PAINTED**  
OLYMPUS WHITE | SW 6253
- 2 LOWER CLADDING/ TRIM/ CORNICES**  
**SHERWIN WILLIAMS**  
ICE CUBE | SW 6252
- 3 BAYS AND PANELIZED WINDOWS**  
**SHERWIN WILLIAMS**  
LAZY GRAY | SW 6254
- 4 UPPER CLADDING/ ROOF TERRACE/ TRIM/ CORNICES**  
**SHERWIN WILLIAMS**  
EXTRA WHITE | SW 7006
- 5 FRONT DOOR**  
**SHERWIN WILLIAMS**  
CLOAK GRAY | SW 6278
- 6 GUTTERS AND DOWNSPOUTS**  
**SHERWIN WILLIAMS**  
BLACK EMERALD | SW 2936
- 7 WINDOWS**  
**SHERWIN WILLIAMS**  
WHITE
- 8 BALCONY RAILING**  
**SHERWIN WILLIAMS**  
BLACK
- 9 GARAGE DOOR**  
**WAYNE DALTON**  
TAUPE | SW 6035

1

2

3

4

5

6

7

8

9

# Designer Appointed Features | INTERIOR SELECTIONS

Designer Appointed Features are home details and finishes curated by the talented design professionals responsible for the distinctive looks found in our model homes.

## 1 WALL PAINT

### Manufacturer Product

Color | Size or Description

## 2 EXTERIOR DOOR HANDLES

### KWIKSET

SATIN NICKEL | AMADOR

## 3 INTERIOR DOOR HANDLES

### KWIKSET

SATIN NICKEL | LADERA LEVER

## 4 FLOORING-CARPET

### SHAW

WEATHERED | STONE PATH

## 5 FLOORING-HARDWOOD

### SHAW

HIGHLIGHTED OAK | BRIO PLUS

## 6 LIGHTING

### PROGRESS

EMBLEM | LED

## 7 LIGHTING

### PROGRESS

EMBLEM | LED

## 8 [INTERIOR SELECTION]

### Manufacturer Product

Color | Size or Description

## 9 [INTERIOR SELECTION]

### Manufacturer Product

Color | Size or Description

1



4

2



3



5



6





# Designer Appointed Features | KITCHEN

Designer Appointed Features are home details and finishes curated by the talented design professionals responsible for the distinctive looks found in our model homes.

## 1 CABINETS

### DIAMOND VIBE

WHITE | BRYANT

## 2 HARDWARE

### JEFFERY ALEXANDER

POLISHED CHROME | DRAWER SQUARE PULL  
DOOR KNOB

## 3 COUNTERTOP-ISLAND

### SILESTONE

CEMENTO | QUARTZ

## 4 COUNTERTOP-PERIMETER

### SILESTONE

CEMENTO | QUARTZ

## 5 BACKSPLASH

### BAKER BLVD

WHITE GLOSS | HERRINGBONE 3X6 WHITE  
GROUT

## 6 FLOORING-HARDWOOD

### SHAW

BRIO | HIGHLIGHT OAK

## 7 FAUCET

### KOHLER

MATTE BLACK | CRUE FAUCET

## 8 SINK

### KOHLER

STAINLESS | SINGLE BOWL

## 9 LIGHTING-ISLAND

### PROGRESS

BRUSHED NICKEL | ALEXA

## 10 LIGHTING-DINING

### PROGRESS

BRUSHED NICKEL | ALEXA



1



2



3



4

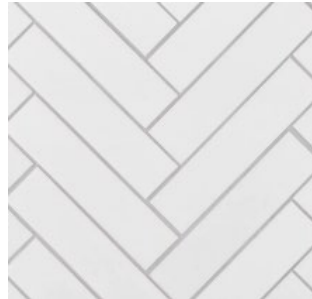

5



6



7



8



9



10

# Designer Appointed Features | KITCHEN APPLIANCES

Designer Appointed Features are home details and finishes curated by the talented design professionals responsible for the distinctive looks found in our model homes.

## 1 REFRIGERATOR

### Manufacturer Product

Color | Size or Description

## 2 RANGE

### WHIRLPOOL

STAINLESS | WFE515S0JS

## 3 VENT HOOD

### WHIRLPOOL

STAINLESS | WVV53UC0LS

## 4 MICROWAVE

### SHARP

STAINLESS | KB6524PS

## 5 DISHWASHER

### WHIRLPOOL

STAINLESS | WDT750SAKZ

1

2



3



4



5

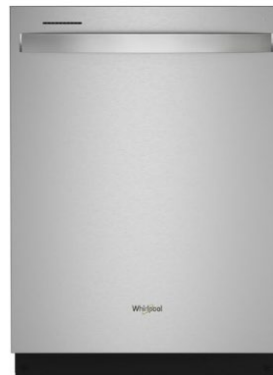

# Designer Appointed Features | POWDER ROOM

Designer Appointed Features are home details and finishes curated by the talented design professionals responsible for the distinctive looks found in our model homes.

## 1 PEDESTAL SINK

KOHLER

PEDESTAL | SACRAMENTO

## 2 FAUCET

KOHLER

POLISHED CHROME | SIMPLICE 8"

## 3 TOILET

KOHLER

WHITE | WELLWORTH STANDARD HEIGHT

## 4 FLOORING

SHAW

BRIO | HIGHLIGHT OAK

## 5 LIGHTING

PROGRESS

EMBLEM | LED

## 6 BATH ACCESSORIES

FRAMED MIRROR

24X36 |

1



2



3



4



5



6





# Designer Appointed Features | PRIMARY BATHROOM

Designer Appointed Features are home details and finishes curated by the talented design professionals responsible for the distinctive looks found in our model homes.

## 1 VANITY CABINETS

**DIAMOND**  
WHITE | BRYANT

## 2 HARDWARE

**JEFFERY ALEXANDER**  
CHROME | DRAWER SQUARE PULL AND DOOR KNOB

## 3 COUNTERTOP

**HI-MACS**  
NORDIC WHITE | ACRYLIC

## 4 FAUCET

**KOHLER**  
POLISHED CHROME | SIMPLICE 8" SPREAD

## 5 SINK

**KOHLER**  
WHITE | RECTANGULAR UNDERMOUNT

## 6 SHOWER TILE—WALLS

**BAKER BLVD**  
WHITE | 4X12 VERTICAL STACKED TO 84"

## 7 SHOWER TILE—FLOOR

**EMSER**  
SILHOUETTE SHADOW | 12X24 OFFSET PATTERN

## 8 SHOWER FIXTURES

**KOHLER**  
POLISHED CHROME | SIMPLICE

## 9 SHOWER FLOOR

**BAKER BLVD**  
TAUPE | 2X2

## 10 TOILET

**KOHLER**  
WHITE | WELLWORTH STANDARD HEIGHT

## 11 SHOWER DOOR

**FRAMELESS**  
CHROME HARDWARE | 80"



1



2

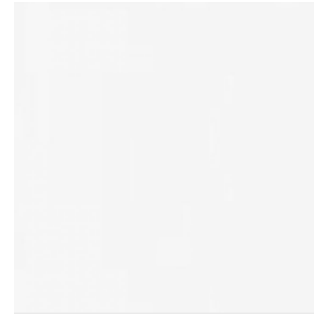

3



4



5



6

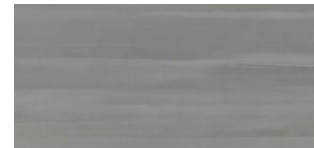

7



8

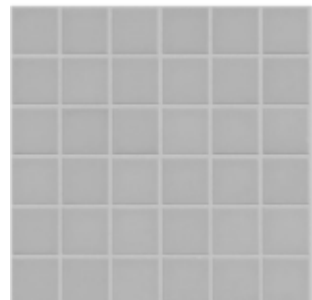

9



10



11

# Designer Appointed Features | SECONDARY BATHROOM

Designer Appointed Features are home details and finishes curated by the talented design professionals responsible for the distinctive looks found in our model homes.

## 1 VANITY CABINETS

**DIAMOND**  
WHITE | BRYANT

## 2 HARDWARE

**JEFFERY ALEXANDER**  
CHROME | DRAWER SQUARE PULL AND DOOR KNOB

## 3 COUNTERTOP

**HI-MACS**  
NORDIC WHITE | ACRYLIC

## 4 FAUCET

**KOHLER**  
POLISHED CHROME | SIMPLICE 8" SPREAD

## 5 SINK

**KOHLER**  
WHITE | RECTANGULAR UNDERMOUNT

## 6 SHOWER TILE—WALLS

**OMEGA** | 12X24 OFFSET PATTERN

## 7 SHOWER TILE—FLOOR

OMEGA | 12X24 OFFSET PATTERN

## 8 SHOWER FIXTURES

**KOHLER**  
POLISHED CHROME | SIMPLICE

## 9 TOILET

**KOHLER**  
WHITE | WELLWORTH STANDARD HEIGHT

## 10 SHOWER DOOR

FRAMELESS 80" CHROME



1



2



3

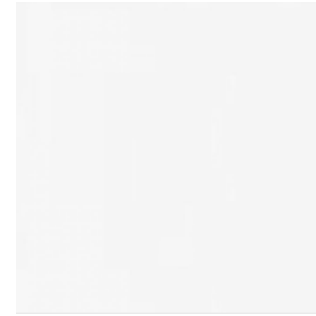

4



5



6



7



8



9

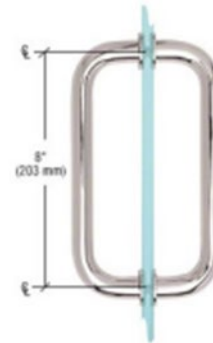

10

# Designer Appointed Features | SECONDARY BATHROOM

Designer Appointed Features are home details and finishes curated by the talented design professionals responsible for the distinctive looks found in our model homes.

## 1 VANITY CABINETS

**DIAMOND**  
WHITE | BRYANT

## 2 HARDWARE

**JEFFERY ALEXANDER**  
CHROME | DRAWER SQUARE PULL AND DOOR KNOB

## 3 COUNTERTOP

**HI-MACS**  
NORDIC WHITE | ACRYLIC

## 4 FAUCET

**KOHLER**  
POLISHED CHROME | SIMPLICE 8" SPREAD

## 5 SINK

**KOHLER**  
WHITE | RECTANGULAR UNDERMOUNT

## 6 SHOWER TILE—WALLS

**OMEGA** | 12X24 OFFSET PATTERN

## 7 SHOWER TILE—FLOOR

OMEGA | 12X24 OFFSET PATTERN

## 8 SHOWER FIXTURES

**KOHLER**  
POLISHED CHROME | SIMPLICE

## 9 TUB

**Manufacturer Product**  
Color | Size or Description

## 10 TOILET

**KOHLER**  
WHITE | WELLWORTH STANDARD HEIGHT



1



2

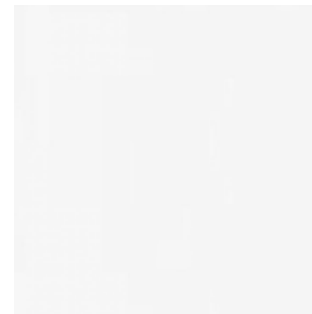

3



4



5



6

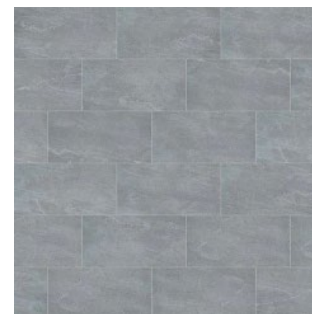

7



8



9



10